

ABBREVIATIONS

ABL - ABOVE BASELINE	MGO - MARINE GAS OIL
ACC - ACCESS	MPS - MULTI-PURPOSE SPACE
ARRGT- ARRANGEMENT	MTR - MOTOR
BHD - BULKHEAD	N&F - NEAR SIDE & FAR SIDE
BKT(S)- BRACKET(S)	NS - NEAR SIDE
BT - BOW THRUSTER	OA - OVERALL
C - CENTER	OFF - OFFICER
CL - CENTERLINE	OUTBD- OUTBOARD
CL - CHAIN LOCKER	OVFLW- OVERFLOW
COMM - COMMUNICATIONS	PLATF - PLATFORM
COMPT- COMPARTMENT	PROP - PROPULSION
CONV - CONVERTER	P/S - PORT & STARBOARD
DB - DOUBLE BOTTOM	QTRDK- QUARTERDECK
DBL - DOUBLE	RO/RO - ROLL-ON/ROLL-OFF
DK - DECK	RM - ROOM
DKHSE- DECKHOUSE	RWT - RAISED WATER TIGHT
ECR - ENGINE CONTROL ROOM	SD - SLIDING DOOR
EDG - EMERGENCY DIESEL GEN	SEC - SECURITY
EGL - EMERGENCY GEAR LKR	SERV - SERVICE
ER - ENGINE ROOM	SETT - SETTLING
FR - FRAME	SGL - SINGLE
FS - FAR SIDE	SPCG - SPACING
FWBT - FRESH WTR BALLAST TK	STBD - STARBOARD
FWD - FORWARD	STOR - STORES (STORAGE)
FWT - FRESH WATER TANK	SWBD - SWITCHBOARD
GEN - GENERATOR	SWBT - SALT WTR BALLAST TK
HVR - HIGH VOLTAGE ROOM	SWTD - SLIDING WT DOOR
INBD - INBOARD	TK - TANK
INCIN - INCINERATOR	W - WOMEN's
IWO - IN WAY OF	W/ - WITH
LKG - LOOKING	W/O - WITHOUT
LKR - LOCKER	W/R - WASH ROOM
LO-LO - LIFT ON/LIFT OFF	WBT - WATER BALLAST TANK
LONGL - LONGITUDINAL	WT - WATER TIGHT
M - MEN's	WTD - WATER TIGHT DOOR
MACHY- MACHINERY	WTR - WATER
	XFMR - TRANSFORMER

PRINCIPAL CHARACTERISTICS

LENGTH OVERALL _____	159.74 m (524'-1")
LENGTH BETWEEN PERPENDICULARS _____	154.00 m (505'-3")
BEAM _____	27.0 m (88'-7")
DEPTH (MAIN DECK AT SIDE) _____	16.8 m (55'-1 1/2")
DESIGN DRAFT _____	6.50 m (21'-4")
LOAD LINE DRAFT _____	7.25 m (23'-9")
SCANTLING DRAFT _____	7.50 m (24'-7")
PROPULSION _____	15,700 kW DIESEL ELECTRIC
DESIGN SPEED AT LOAD LINE DRAFT _____	18 KNOTS, 15% SEA MARGIN
DISPLACEMENT (LOAD LINE DRAFT) _____	19,237 MT

ACCOMMODATIONS

CADETS _____	600
OFFICERS, FACULTY, STAFF & CREW (SINGLE OCCUPANCY CABINS) _____	100
ADDITIONAL STAFF (WITH DOUBLE OCCUPANCY) _____	60

GENERAL CARGO

RO-RO SPACE _____	1015 m2 (10,925 ft2)
CARGO CRANE _____	35 MT x 24 m

REVISIONS (cont'd)

No.	DESCRIPTION	BY/DATE/APPD

REVISIONS

No.	DESCRIPTION	BY/DATE/APPD
-	INITIAL ISSUE	MDS 12/19/16 EVR
1	1. SEPARATED MPS FROM DKHSE FRS 65 & 70; MPS CONFIGURATION & AREA REVISED; MAIN DK PANTRY RELOCATED TO SUIT; ADDED SEPARATE MPS ARRG T TO DRAWING (SHEET 5) FOR CLARIFICATION. 2. REVISED HOUSE AFT SIDESHELL BRACKET GEOMETRY. 3. ADDED NAVIGATION LIGHTS, MASTS & FLAG STAFFS. 4. SHIFTED LIFERAFT DAVITS AFT TO FRAME 64 P/S. 5. INCREASED SIZE OF SIDESHELL PILLARS/BKTS AT FRS 93 & 123. 6. ADDED BUNKER STATIONS P/S FRS 45-51. 7. RELOCATED AFT CABIN WINDOWS 02 & 03 LEVELS FROM HOUSE SIDE TO AFT BHD FR 70. 8. CORRECTED STORES CRANE OUTLINE FWD P/S. 9. INERGEN RM 2 (2ND DK, PORT SIDE AFT) RELOCATED FWD ONE COMPT & RENAMED INERGEN RM 1; ADJACENT STAIR TOWER RELOCATED AFT OF NEW INERGEN RM 1; REMOVED INERGEN DOOR TO CORRIDOR & ADDED VERTICAL LADDER ACCESS TO DOOR TO OUTSIDE VIA NEW VESTIBULE LOCATED INSIDE MPS. 10. RELOCATED OLD INERGEN RM 1 (3RD DK, STBD SIDE AFT) TO MAIN DK PORT SIDE FR 75 & RENAMED INERGEN ROOM 2; EGL2 MOVED & FIRE CONTROL RM REMOVED TO SUIT; FORMER INERGEN SPACE REDESIGNATED AS STORES. 11. MACHY CASING MADE TIGHT AT MAIN DECK. 12. ADDED DOOR TO FUNNEL AT 05 LEVEL. 13. ADDED DOOR TO CASING AT TOP OF MPS. 14. EXTENDED GRATING AT TOP OF MPS. 15. ADDED CASING AROUND 4TH DK LADDER UP, FR 95 STBD INBD. 16. PROVIDED 2 MEANS OF ESCAPE TO GYMNASIUM, 4TH DK FWD (ABS COMMENT); COMPARTMENT AREA & GEOMETRY CHANGED TO SUIT. 17. RECONFIGURED LADDER ARRG T UP, TANK TOP FR 100 CL, TO SUIT 4TH DK ARRG T. 18. MOTOR ROOM ESCAPE TRUNKS MOVED 750mm INBD.	MDS 02/28/17 EVR



Herbert Engineering Corp.
Naval Architects San Francisco Glasgow
Marine Engineers Annapolis Shanghai
Ocean Engineers www.herbert.com

DRWN: MDS	DATE: DEC 19, 2016	SCALE: NOTED
CHKD: CRS	APPD: EVR	ACADFILE: 150170301-1
PROJECT FILE: 2015-017-03 (NSMV ph3 Arrangements)		PLOTSCALE: 1:1 (on 11"x17")

ABS APPROVAL: -
-



**United States
Maritime Administration**

**NSMV PHASE 3
GENERAL ARRANGEMENT**

OWNER APPVL: -	HEC DWG No.: 2015-017-03-01
DATE: -	
FILE: -	SHEET 1 OF 8 REV 1

DRAWING INDEX

SHEET 1	PRINCIPAL PARTICULARS
SHEET 2	WATERLINE & OUTBOARD PROFILES
SHEET 3	PORT & STBD INBOARD PROFILES
SHEET 4	PLANS AT 05 & 04 LEVELS
SHEET 5	PLANS AT 03 & 02 LEVELS
SHEET 6	PLANS AT 01 LEVEL & MAIN DECK
SHEET 7	PLANS AT 2ND & 3RD DECKS
SHEET 8	PLANS AT 4TH & TANKTOP DECKS

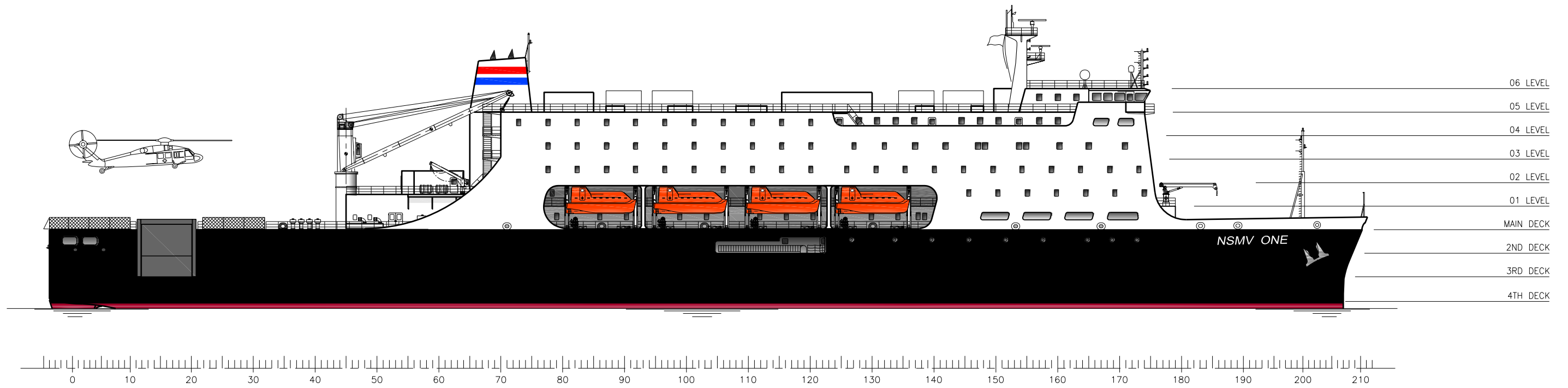

WATERLINE PROFILE

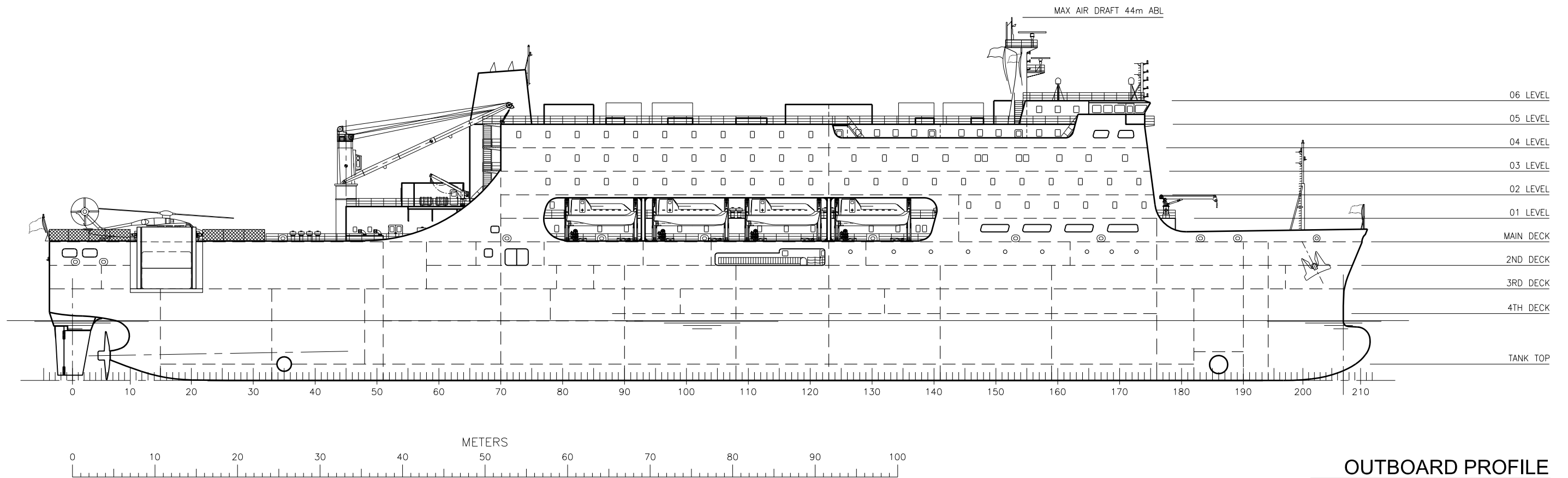

OUTBOARD PROFILE

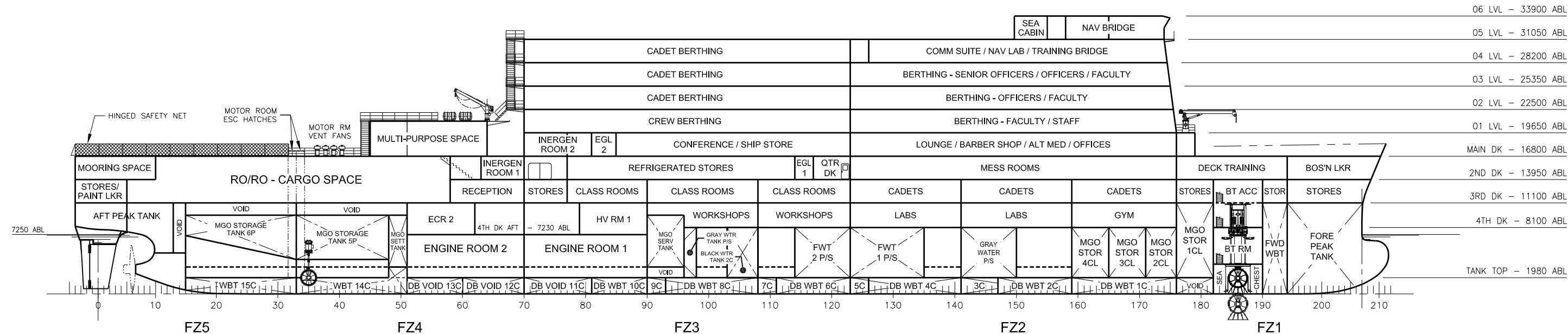

INBOARD PROFILE - PORT

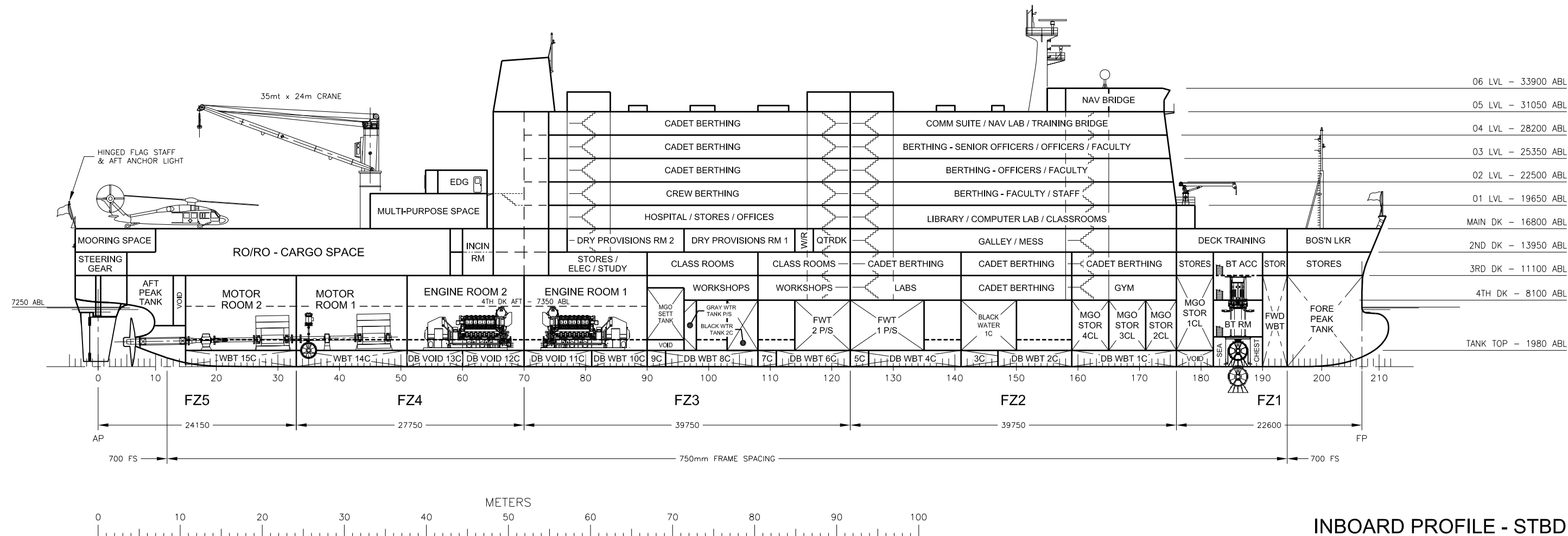

INBOARD PROFILE - STBD

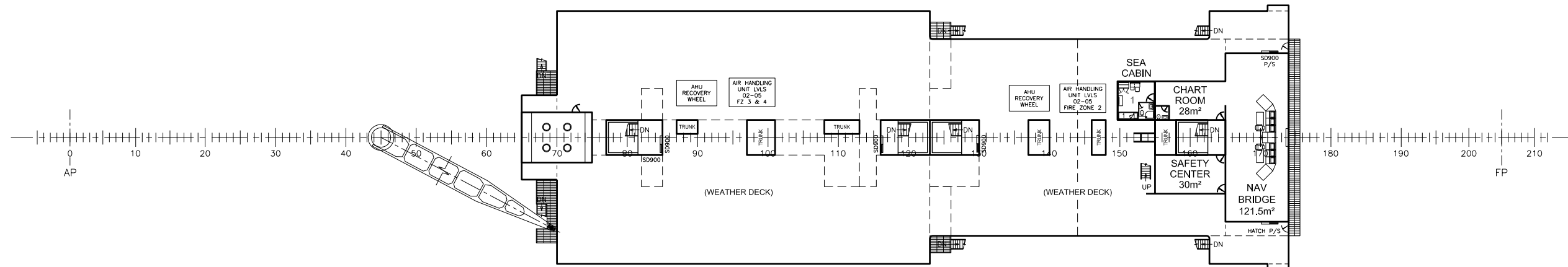

PLAN AT 05 LEVEL - 31050 ABL

I FZ5 I FZ4 I FZ3 I FZ2 I FZ1 I

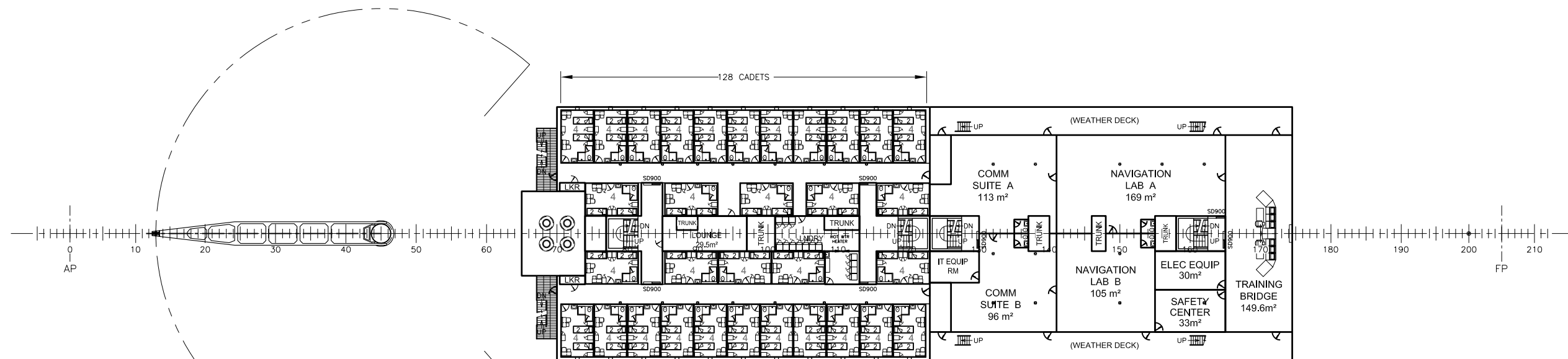

PLAN AT 04 LEVEL - 28200 ABL

0 10 20 30 40 50 60 70 80 90 100 METERS

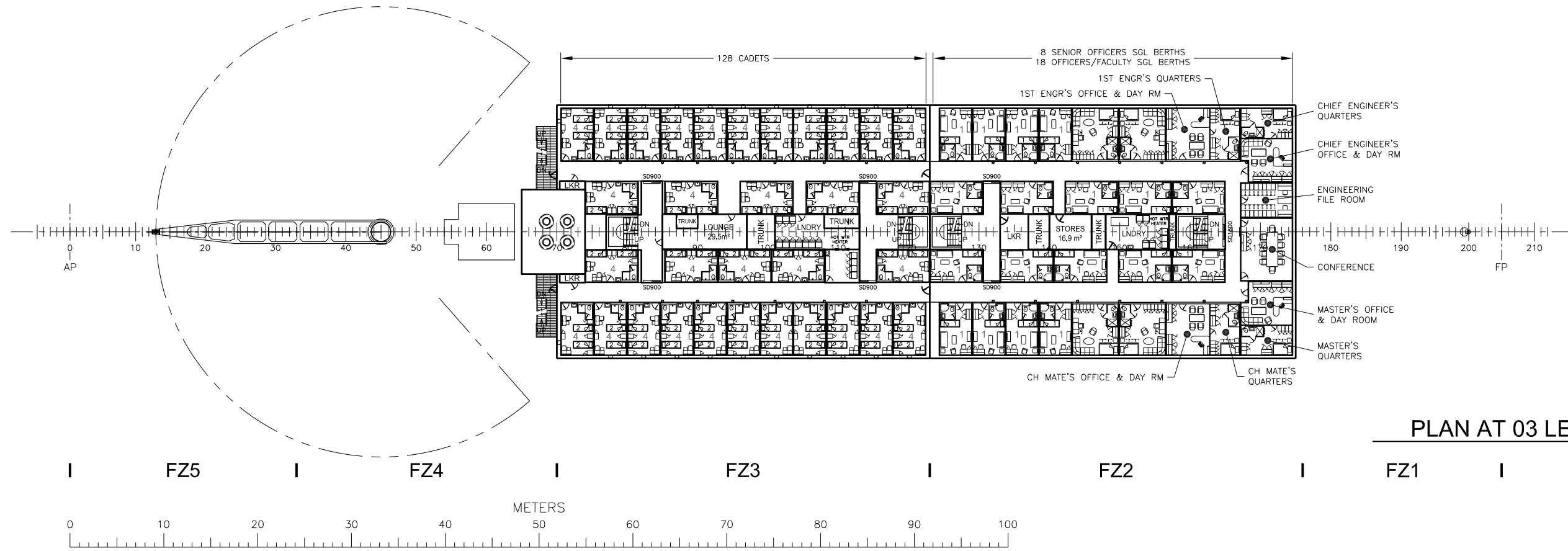

PLAN AT 03 LEVEL - 25350 ABL

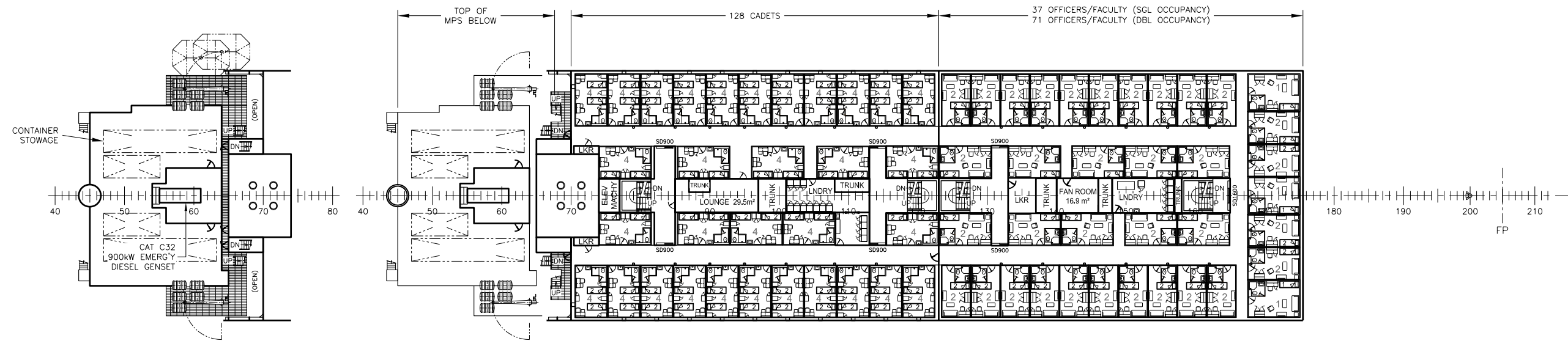

PLAN AT TOP OF MPS - 21075 ABL

PLAN AT 02 LEVEL - 22500 ABL

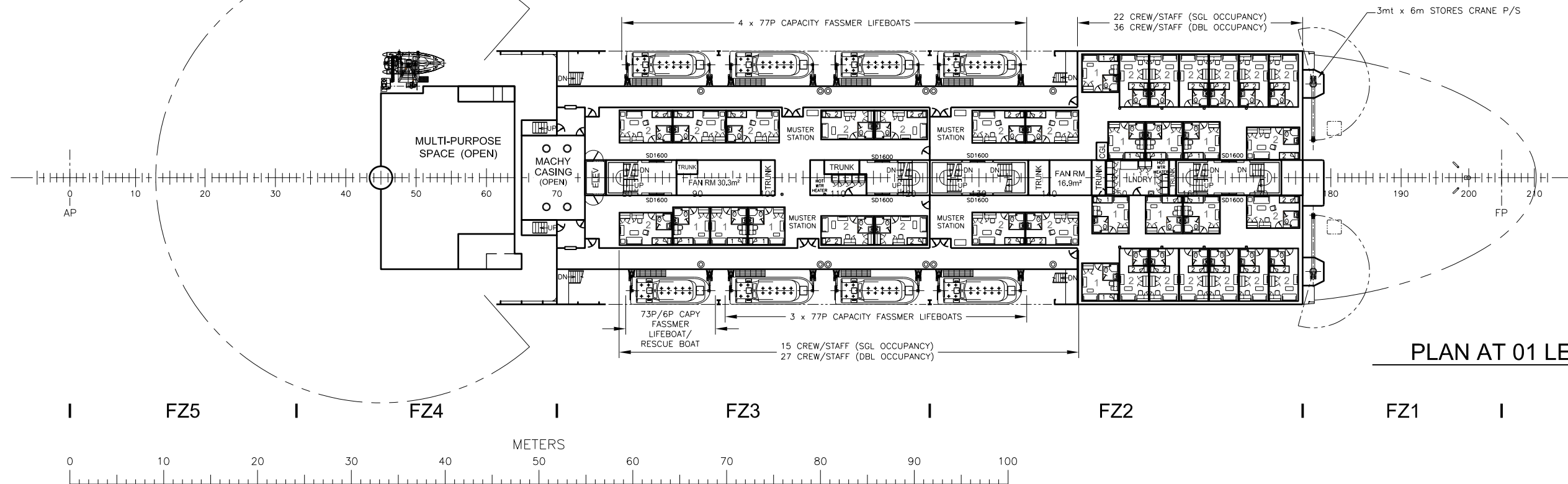

PLAN AT 01 LEVEL - 19650 ABL

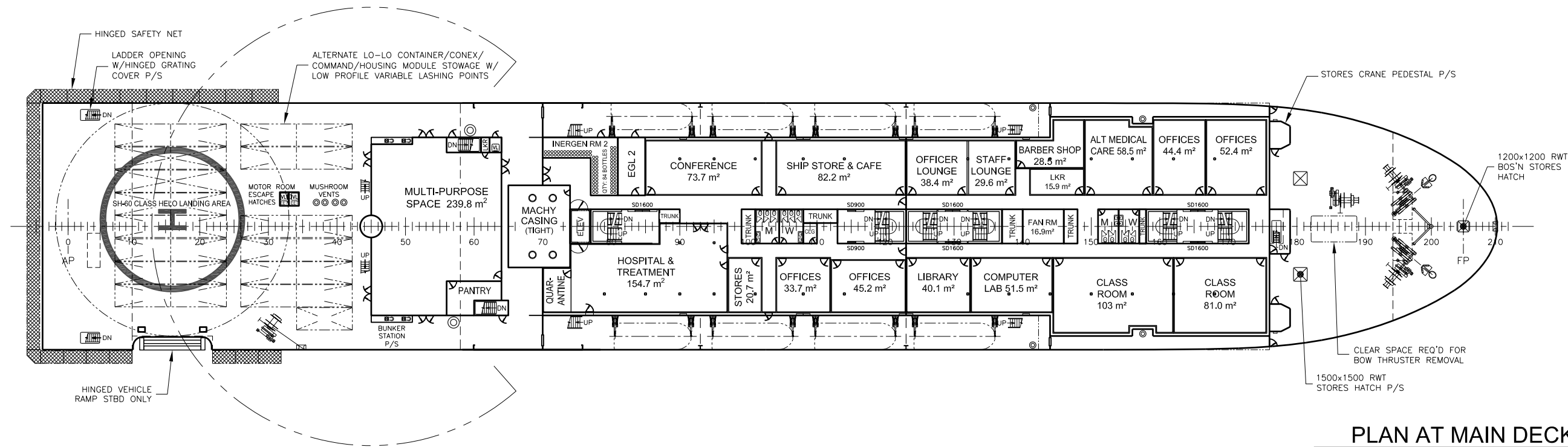

PLAN AT MAIN DECK - 16800 ABL

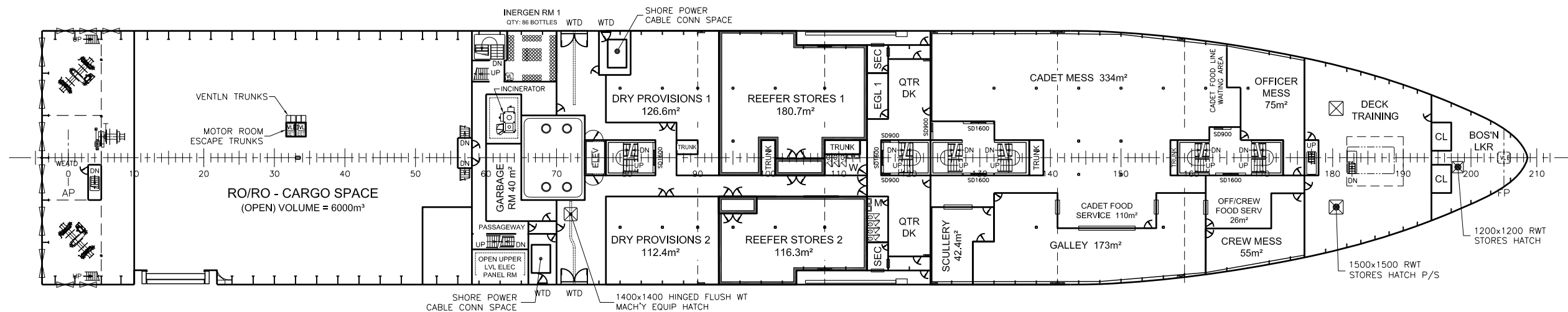

2D DECK - 13950 ABL

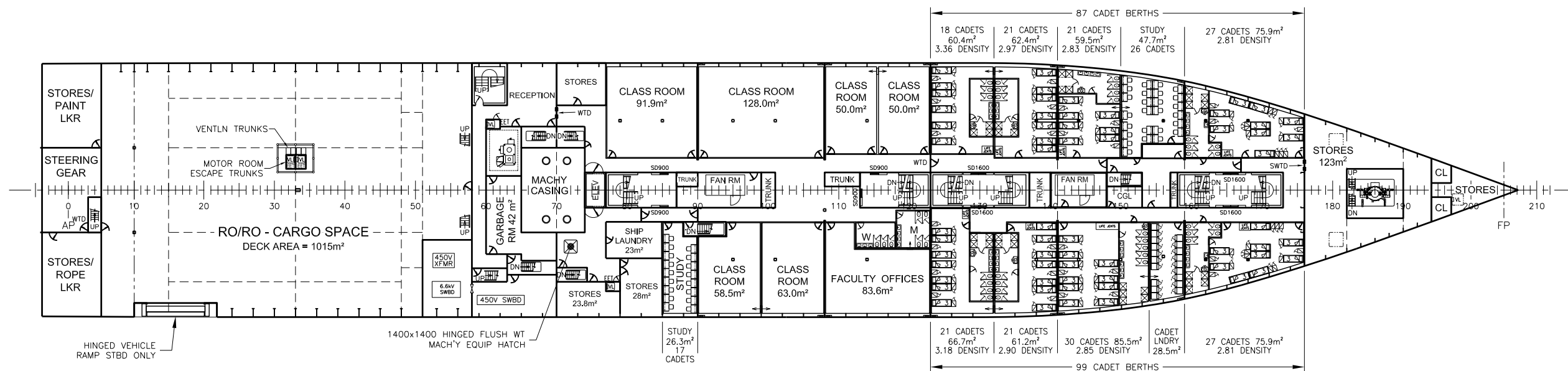
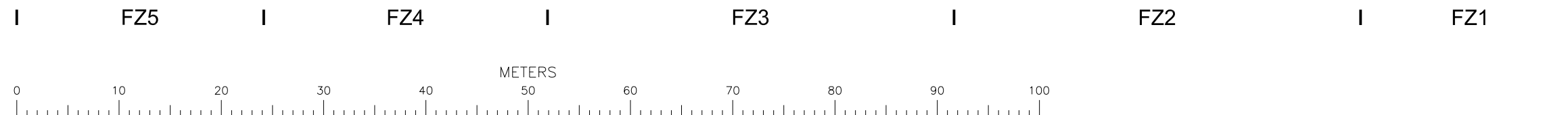

3RD DECK - 11100 ABL

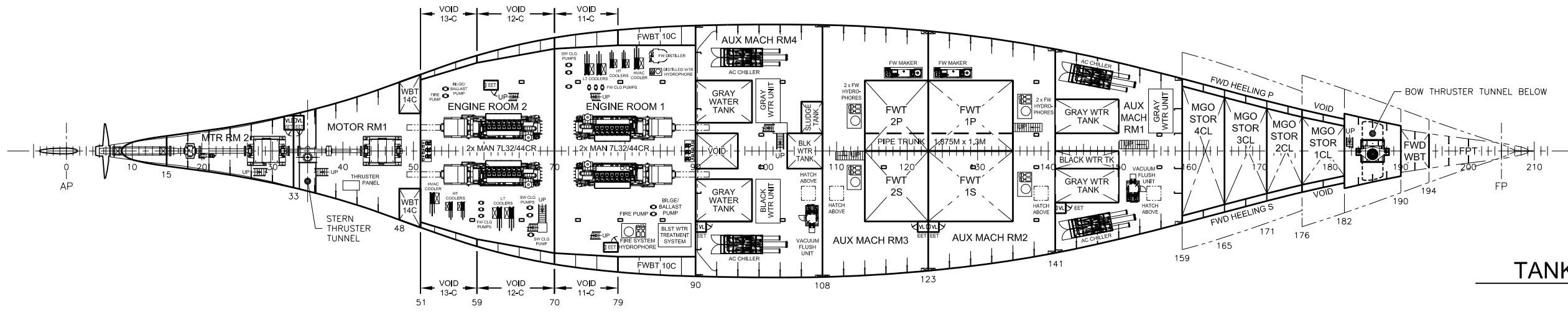
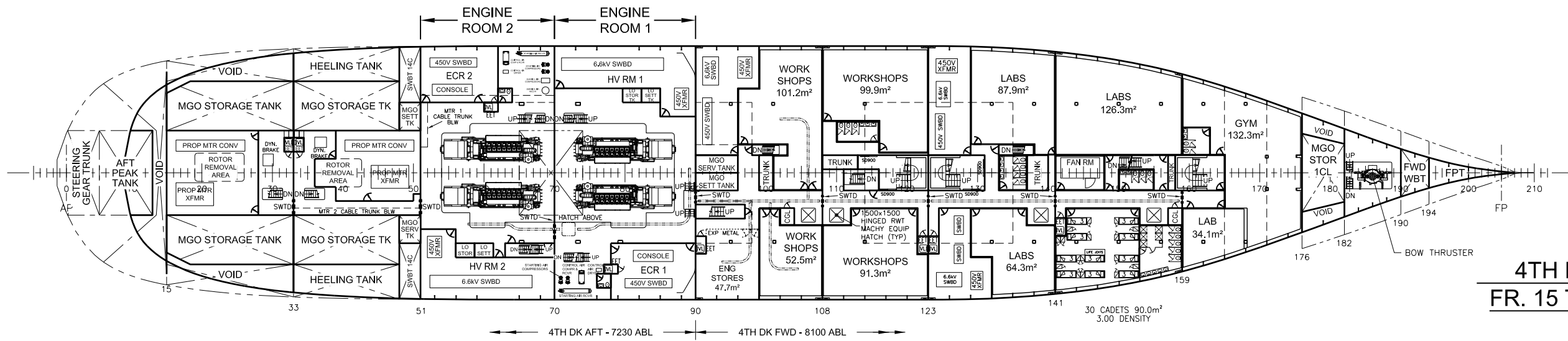

FZ5 FZ4 FZ3 FZ2 FZ1

